

Case 9

CAR	VW Transporter T5 / T6	PART NO.	SVWS049D
YEAR	VARIES	FIT KITS	218FK
NOTES	VARIES	FEATURES	N/A

Scorpion Exhaust Cat-back system Daytona

fits to:

VW Transporter T5 SWB & LWB 1.9TDi (85ps & 104ps) 03-09
 VW Transporter T5 SWB & LWB 2.5 TDi (130ps & 174ps) 03-09
 VW Transporter T5 SWB & LWB 2.0 (84ps & 102ps) 10-15
 VW Transporter T5 SWB & LWB 2.0 (140ps) 10-15

Scorpion Exhaust Particulate Filter-back Daytona

fits to:

VW Transporter T5 SWB & LWB 2.0 BiTDi (180ps) 10-15
 VW Transporter T6 SWB & LWB 2.0 BiTDi (204ps) 15-Current

Parts in this kit

1x 705VW
 1x 699VW
 1x 707VW
 1x 710VW
 1x 711VW
 1x 702VW64
 1x 712VW64
 1x Z028.20304
 1x 218FK

CAR	VW Transporter T5 / T6	PART NO.	SVWS049D
YEAR	VARIABLES	FIT KITS	218FK
NOTES	Where not supplied use original fittings. Only use Item 2 when fitting Scorpion exhaust to a LONG WHEEL BASE MODELS.	FEATURES	Pipe diameter:- 70mm , 2 3/4"

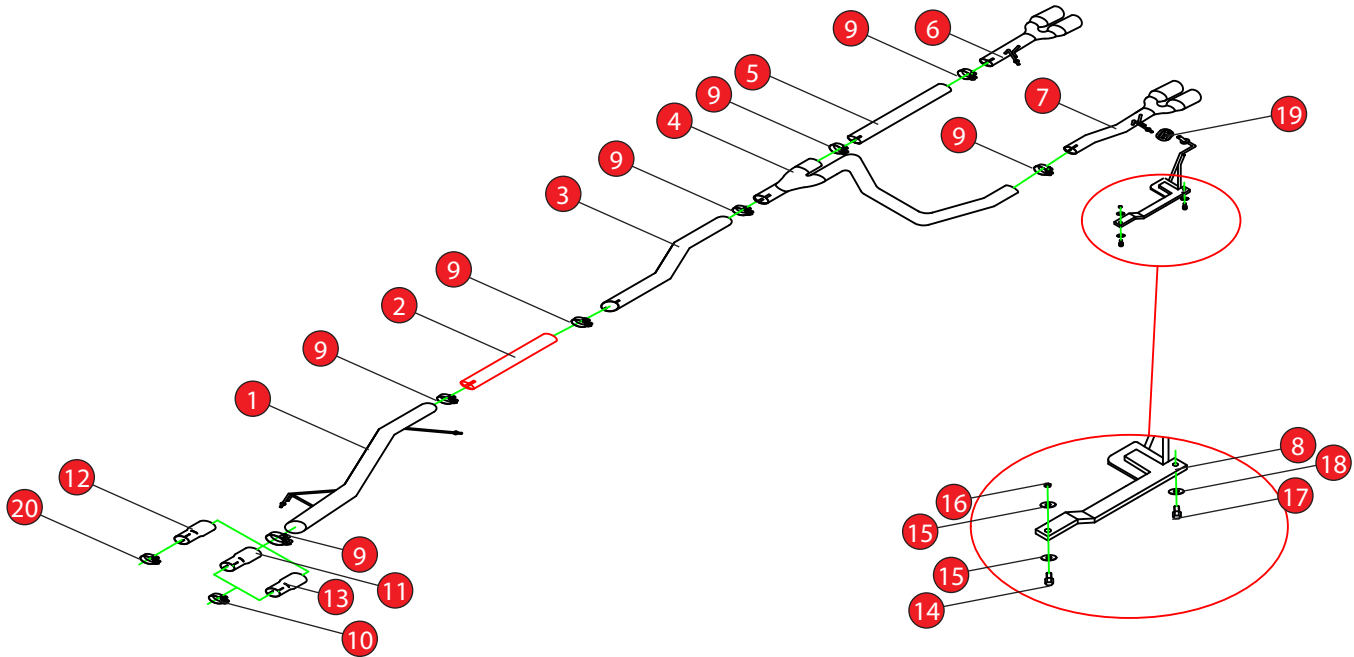

NO.	PART NO.	DESCRIPTION	QTY
1	705VW	Centre No Silencer	1
2	707VW	Link Pipe (Only use when fitting Scorpion exhaust to long wheel base models)	1
3	699VW	Centre Pipe	1
4	710VW	Y Piece Link Pipe	1
5	711VW	R/H Trim Link Pipe	1
6	702VW64	R/H Tail Pipe With Daytona Trims	1
7	712VW64	L/H Tail Pipe With Daytona Trims	1
8	Z028.20304	Hanging Bracket	1
Fit Kit			
9	Z016.10063	72mm H/D Clamp	7
10	Z016.10005	63 - 68 Clamp	1
11	AD03	Adaptor	1
12	AD04	Adaptor (Use when fitting to 1.9 engine vehicles only.)	1
13	AD98	Adaptor (Use when fitting to T6 model.)	1
14	Z017.10044	M8 x 20mm Hex Head Bolt	1
15	Z017.10831	M8 x 17 Washer	2
16	Z017.10062	M8 Nyloc Nut	1
17	Z017.10611	M6 x 20mm Hex Head Bolt	1
18	Z017.12722	M6 Washer	1
19	Z016.10057	Hanging Rubber	1
20	Z016.10004	55 - 59 Clamp	1

E-MARK	N/A
ISSUE	05
DATE	19/06/17
AUTHORISED	M.YDLIBI

Fitting instructions overleaf on next page.

NOTE: ENSURE SCORPION SYSTEM IS CLEAR OF MOVING PARTS AND ALL ORIGINAL FUNCTIONS WORK CORRECTLY.

Checked By _____

Case 9

BIKE	VW Transporter T5 / T6	PART NO.	SVWS049D
YEAR	VARIES	FIT KITS	218FK
NOTES	Where not supplied use original fittings. Only use Item 2 when fitting Scorpion exhaust to a LONG WHEEL BASE MODELS.	FEATURES	Pipe diameter:- 70mm , 2 3/4"

CONTINUED FROM OVERLEAF:



A) You'll need to fit item 8 to the vehicle, where circled remove O.E bolt and replace with item 17 & 18 as shown in line diagram. This is located behind the left hand side (near side) rear wheel.

B) There will be a square hole on the vehicle body(chassis) use items 14, 15 & 16 to bolt item 8 to the vehicle.