

Box: PLOCK 1

BIKE	BMW G650 X	PART NO.	EBM - 61
YEAR	2007 - 09	FIT KITS	OVAL Z039.11273 ROUND Z039.10273
NOTES	Use standard fittings where not supplied <b>Remove standard gasket if fitted.</b>	DB-Killer	SCEXDBK12 - (Type B)

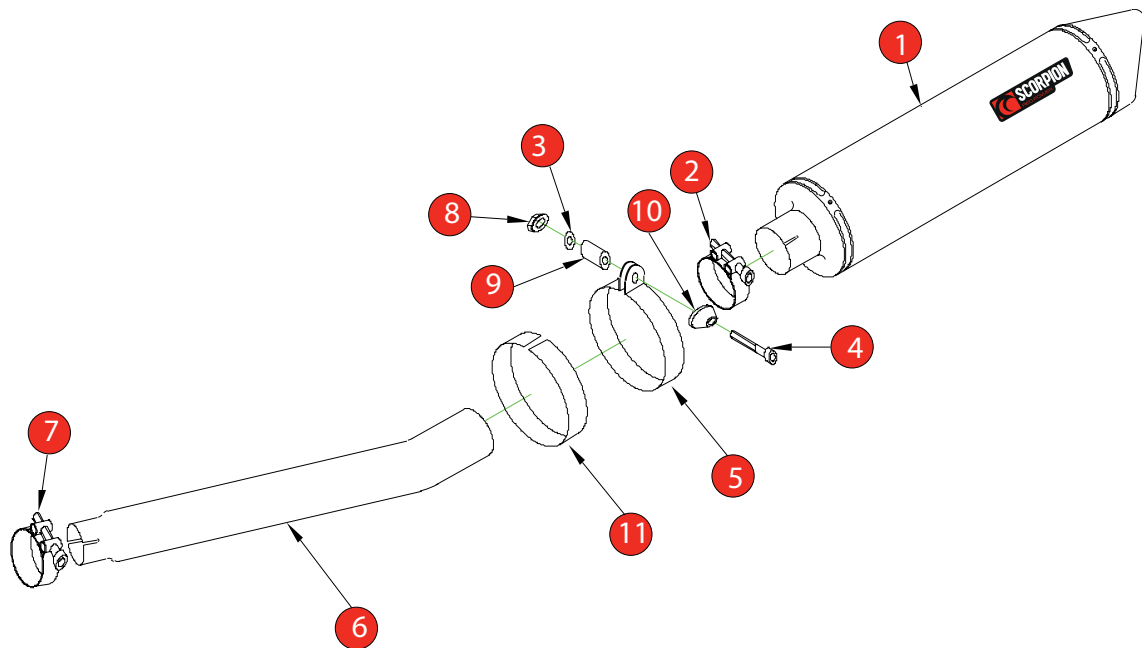

1 450mm Silencer ESC 50	8 M8 Nyloc Nut (Z017.10062)
2 51-54mm Band Clamp (Z016.10002)	9 35mm Aluminium Spacer (Z026.10009)
3 M8 x 17mm Washer (Z017.10831)	10 Aluminium Bolt Finisher (Z026.20068)
4 M8 x 80mm Cap Head Bolt (Z017.10084)	11 Silencer Strap Rubber (Z029.10022)
5 Silencer Strap (R-Z028.10231) OR (O-Z028.10229)	
6 Connecting Pipe CP 449	
7 43-47mm Band Clamp (Z016.10008)	

E-MARK ROUND	BSAU 193a 1990/t3
E-MARK OVAL	BSAU 193a 1990/t3
ISSUE NO.	8
DATE	28/09/2018
AUTHORISED	J.Harkin
CHECKED	

**NOTE:** ENSURE SCORPION SYSTEM IS CLEAR OF MOVING PARTS AND ALL ORIGINAL FUNCTIONS WORK CORRECTLY.

A) Remove original exhaust from bike, taking care to keep all original components in a safe place.

B) Refit Scorpion exhaust as per line diagram above.

C) When fitted take bike for a short ride to ensure all functions are correct.

D) When bike & exhaust are cool enough check all nuts and bolts are still secure.