

Box: PLOCK 2

BIKE	BMW R1200GS	PART NO.	EBM - 65
YEAR	2010 - 12	FIT KITS	OVAL Z039.11372
NOTES	Does Not Fit with OE Panniers Use standard fittings where not supplied <b>Remove standard gasket if fitted.</b>	DB-Killer	SCEXDBK12 - (Type B)

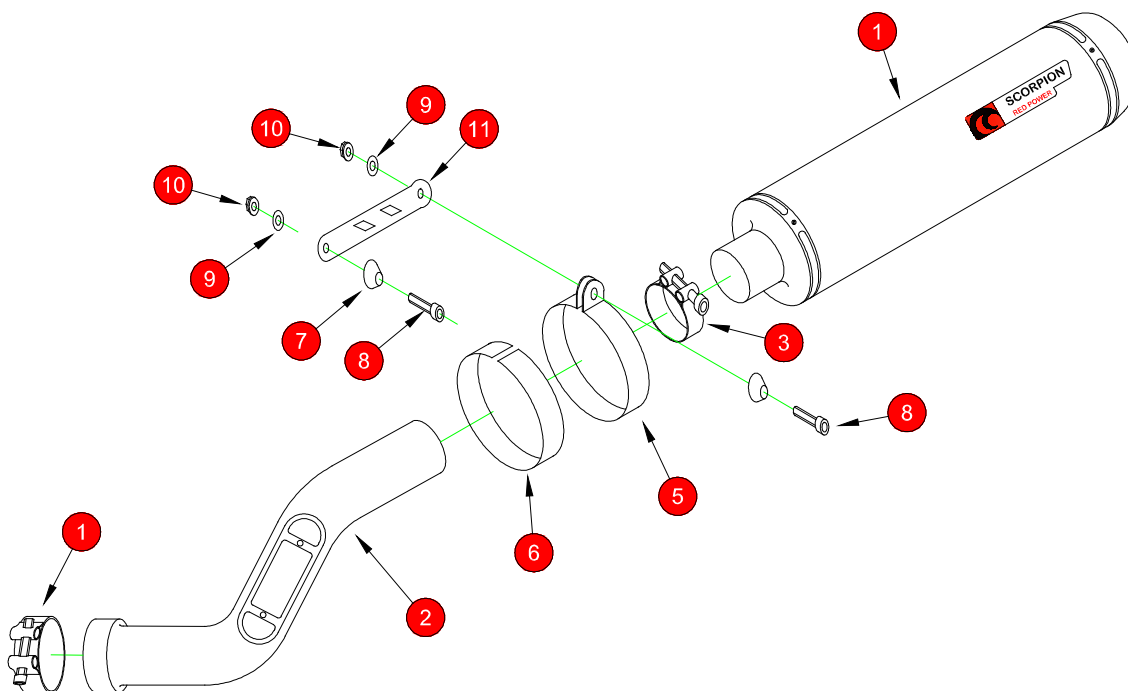

- |  |   |
|--|---|
| 1 450mm Oval Silencer ESC 163          | 8 2 x M8 x 25mm Cap Head Bolts (Z017.10073) |
| 2 Connecting Pipe CP571                | 9 2 x M8 x 17mm Washers (Z017.10831)        |
| 3 51-55mm Band Clamp (Z016.10002)      | 10 2 x M8 x Nylock Nuts (Z017.10062)        |
| 4 63-68mm Band Clamp (Z016.10005)      | 11 Silencer Mounting Bracket (Z015.31040)   |
| 5 Oval Silencer Strap (Z028.10231)     |   |
| 6 Silencer Strap Rubber (Z029.10022)   |   |
| 7 2 x Alloy Bolt Finisher (Z026.20068) |   |

E-MARK ROUND	N/A
E-MARK OVAL	BSAU 193a 1990/t3
ISSUE NO.	3
DATE	28/09/2018
AUTHORISED	J.Harkin
CHECKED	

**NOTE:** ENSURE SCORPION SYSTEM IS CLEAR OF MOVING PARTS AND ALL ORIGINAL FUNCTIONS WORK CORRECTLY.



A) Remove original exhaust from bike, taking care to keep all original components in a safe place.

B) Refit Scorpion exhaust as per line diagram above.

C) When fitted take bike for a short ride to ensure all functions are correct.

D) When bike & exhaust are cool enough check all nuts and bolts are still secure.