

<b>Bike</b>	Yamaha X-Max 300	<b>Part No.</b>	RYA-109
<b>Year</b>	2017-2020	<b>Fit Kit</b>	Z039.10615
<b>Notes</b>	Where not supplied use original fittings	<b>dB Killer</b>	SCEXDBK42 - (Type MM)

Estimated Fitting Time: 60 Minutes

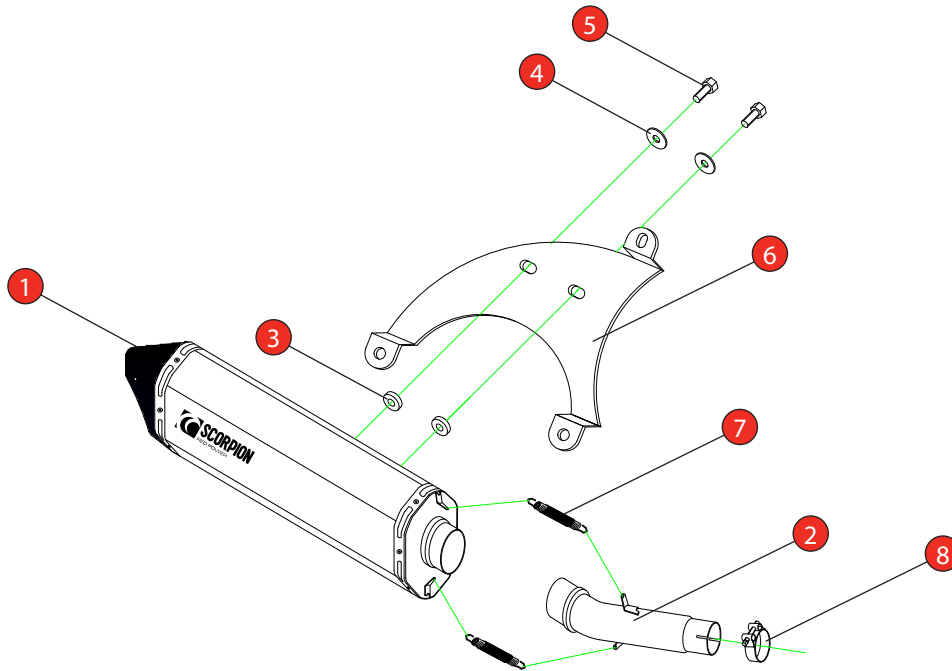

NO.	PART NO.	DESCRIPTION	QTY
1	RSC417	Serket Silencer	1
2	CP971	Connecting Pipe	1
<b>Fit Kit - Z039.10615</b>			
3	Z026.20049	M8 x 5mm Alloy Spacer	2
4	Z017.10831	M8 x 17mm Washer	2
5	Z017.10044	M8 x 20 Hex Head	2
6	Z015.31331	Mounting Bracket	1
7	Z028.10030	Rubber Coated Spring	2
8	Z016.10010	34-37mm Clamp	1

E-MARK	BSAU 193a 1990/t3
DATE	18/03/21
ISSUE	02
AUTHORISED	M.Ydlibi

**NOTE:** ENSURE SCORPION SYSTEM IS CLEAR OF MOVING PARTS AND ALL ORIGINAL FUNCTIONS WORK CORRECTLY.

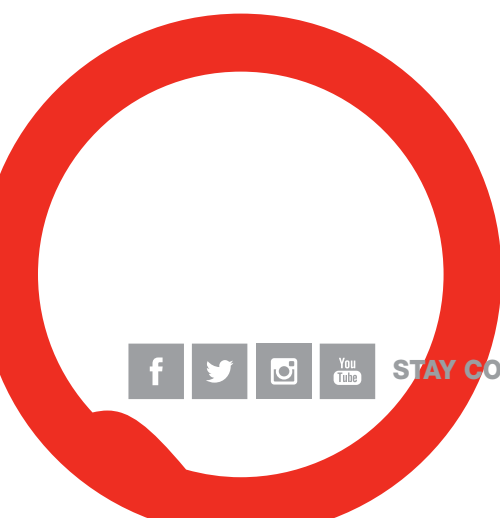

STAY CONNECTED TO RED POWER.

<b>Bike</b>	Yamaha X-Max 300	<b>Part No.</b>	RYA-109
<b>Year</b>	2017-2020	<b>Fit Kit</b>	Z039.10615
<b>Notes</b>	Where not supplied use original fittings	<b>dB Killer</b>	SCEXDBK42 - (Type MM)

Estimated Fitting Time: 60 Minutes



A) Remove original exhaust from bike, taking care to keep all original components in a safe place.

B) Refit Scorpion exhaust as per line diagram above.

C) When fitted take bike for a short ride to ensure all functions are correct.

D) When bike & exhaust are cool enough check all nuts and bolts are still secure.

Thank you for purchasing your Scorpion Silencer.

Care of your exhaust: Please refrain from cleaning silencer with heavy solvents or abrasives!

Vielen Dank Für den kauf eines Scorpion Schalldampfers! Pflegehinweis: Bitte verwenden Sie niemals Scheuermittel oder aggressive Reiniger zur Pflege Ihres Auspuffes!

Merci d'avoir choisi un echappement Scorpion.

Entretien de votre silencieux: Ne pas utiliser de solvants ou de produits abrasifs!

Muchas gracias por adquirir un Silencioso Scorpion. Le recomendamos no limpiar el silencioso con productos abrasivos o aquellos que contengan disolventes.



STAY CONNECTED TO RED POWER.