

Box: PLOCK 1

BIKE	SUZUKI GSF 1250 / 650 BANDIT CARBINE	PART NO.	ESI - 99
YEAR	2007 - 2015 / 2007-2011	FIT KITS	OVAL Z039.11264
NOTES	Use standard fittings where not supplied Remove standard gasket if fitted.	DB-Killer	SCEXDBK12 - (Type B)

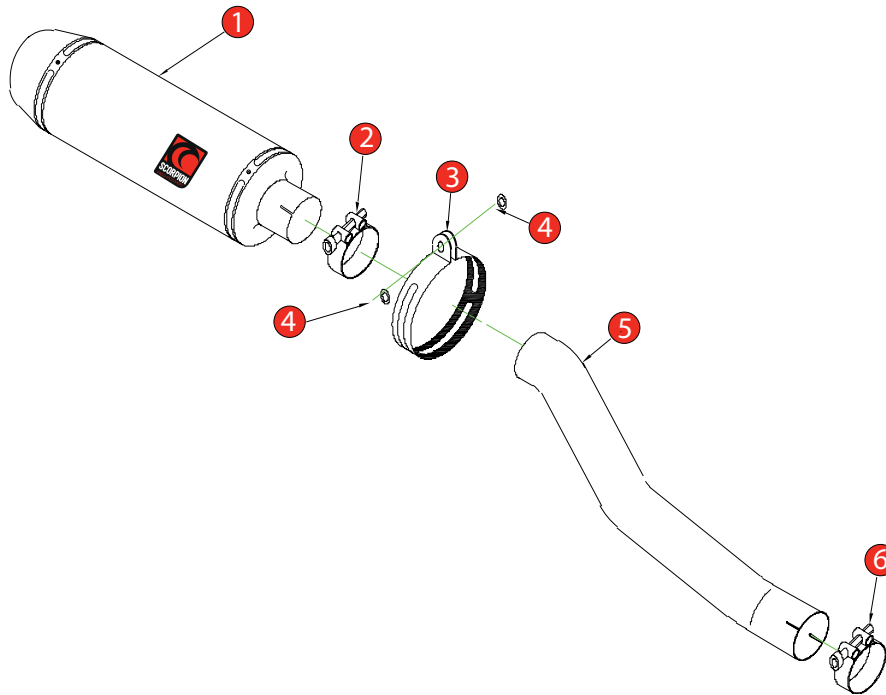

- 1 225mm Silencer ESC 114
- 2 51-55mm Band Clamp (Z016.10002)
- 3 Composite Silencer Strap (Z038.10088)
- 4 2 x M8 x 25mm Washers (Z017.10825)
- 5 Connecting Pipe CP 431
- 6 55-59mm Band Clamp (Z016.10004)
- 7 Bump Stop Kit

E-MARK ROUND	N/A
E-MARK OVAL	BSAU 193a 1990/t3
ISSUE NO.	05
DATE	19/10/2018
AUTHORISED	J.Harkin
CHECKED	

NOTE: ENSURE SCORPION SYSTEM IS CLEAR OF MOVING PARTS AND ALL ORIGINAL FUNCTIONS WORK CORRECTLY.



A) Remove original exhaust from bike, taking care to keep all original components in a safe place.

B) Refit Scorpion exhaust as per line diagram above.

C) When fitted take bike for a short ride to ensure all functions are correct.

D) When bike & exhaust are cool enough check all nuts and bolts are still secure.