

Box: P-Lock 2 x 2

BIKE	HONDA CBF 1000	PART NO.	EHA - 88
YEAR	2006 - 2010	FIT KITS	OVAL Z039.11009 // ROUND Z039.10009
NOTES	Use standard fittings where not supplied Remove standard gasket if fitted.	DB-Killer	2 x SCEXDBK12 - (Type B)

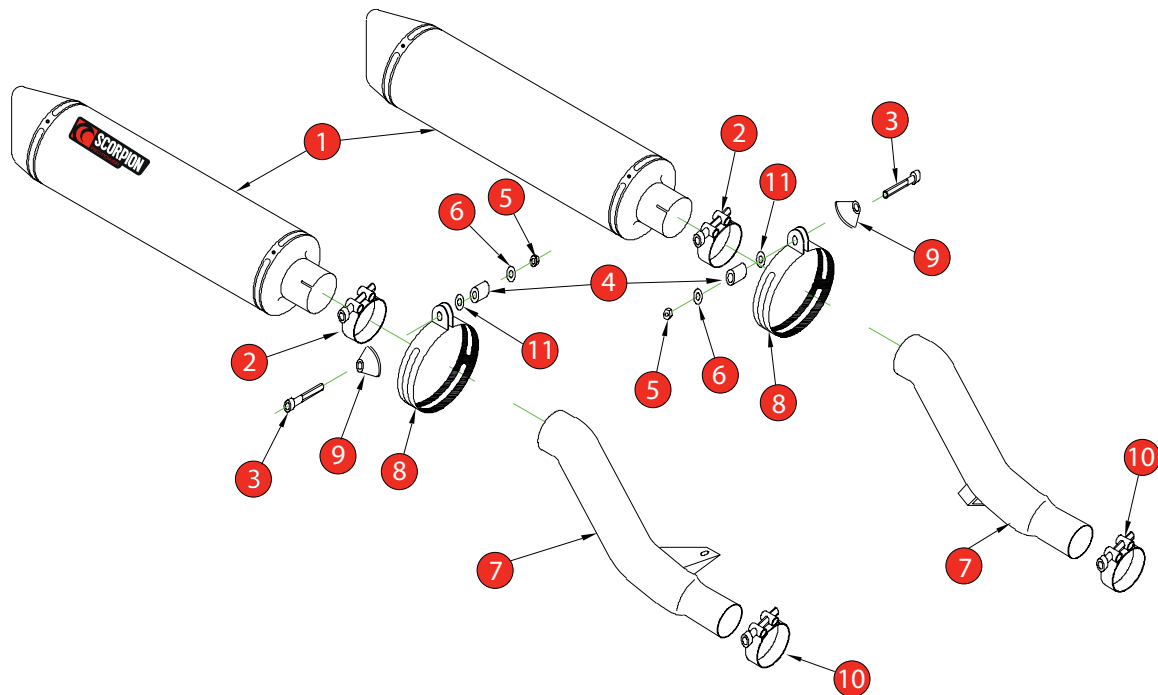

- | | |
|--|--|
| 1 2 x 450mm Silencers ESC 5006 | 8 2 x Comp Silencer Straps (R-Z038.10090) (O-Z038.10088) |
| 2 2 x 55-59mm Band Clamps (Z016.10004) | 9 2 x Aluminium Bolt Finishers (Z026.20068) |
| 3 2 x M8x 80mm Cap Head Bolts (Z017.10084) | 10 2 x 37-40mm Band Clamps (Z016.10006) |
| 4 2 x 25mm Aluminium Spacers (Z026.10007) | 11 2 x M8 x 25mm Washers (Z017.10825) |
| 5 2 x M8 Nyloc Nuts (Z017.10062) | 12 2 x Bump Stop Kits (Z017.10010) |
| 6 2 x M8 x 17mm Washers (Z017.10831) | |
| 7 Connecting Pipes CP355 L/H & CP356 R/H | |

E-MARK ROUND	SC-5007 [ed] 2215
E-MARK OVAL	SC-5006 [ed] 2214
ISSUE NO.	11
DATE	10/10/2018
AUTHORISED	J.Harkin
CHECKED	

NOTE: ENSURE SCORPION SYSTEM IS CLEAR OF MOVING PARTS AND ALL ORIGINAL FUNCTIONS WORK CORRECTLY.

A) Remove original exhaust from bike, taking care to keep all original components in a safe place.

B) Refit Scorpion exhaust as per line diagram above.

C) When fitted take bike for a short ride to ensure all functions are correct.

D) When bike & exhaust are cool enough check all nuts and bolts are still secure.