

Box: PLOCK 2

BIKE	HONDA CBF 600	PART NO.	EHA - 84
YEAR	2004 - 2006	FIT KITS	OVAL Z039.11036 // ROUND Z039.10036
NOTES	Use standard fittings where not supplied Remove standard gasket if fitted.	DB-Killer	SCEXDBK12 - (Type B)

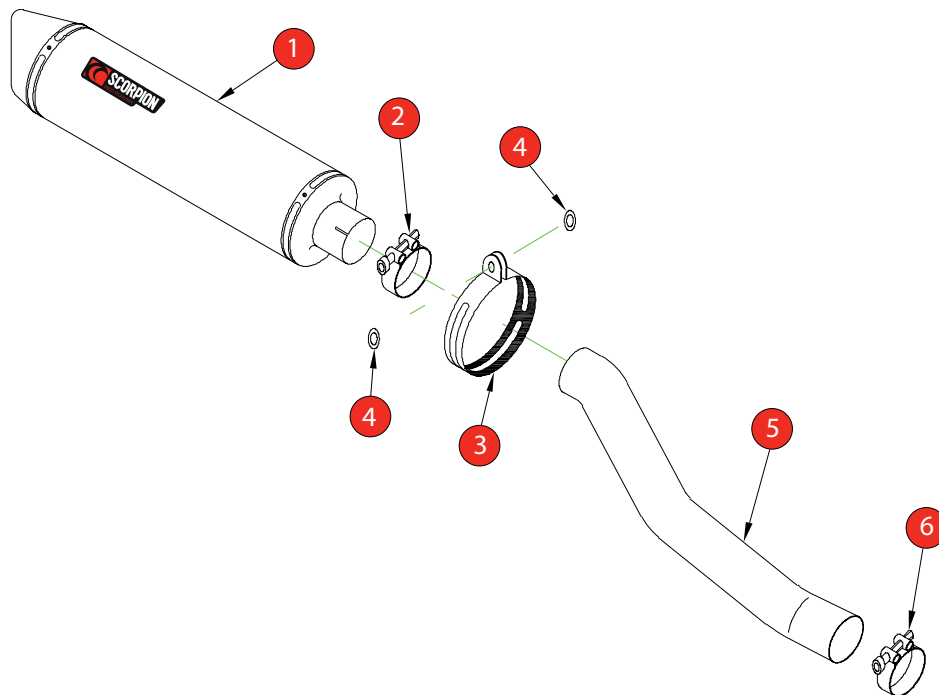

- | | |
|---|--|
| 1 | 450mm Silencer ESC 50 |
| 2 | 51-55mm Band Clamp (Z016.10002) |
| 3 | Composite silencer strap (O-Z038.10088) (R-Z038.10090) |
| 4 | 2 x M8 x 25mm Washers (Z017.10825) |
| 5 | Connecting Pipe CP 244 |
| 6 | 43-47mm Band Clamp (Z016.10008) |

E-MARK ROUND	SCDB-RS [e4] 2035
E-MARK OVAL	SCDB-OS [e4] 2072
ISSUE NO.	08
DATE	10/10/2018
AUTHORISED	J.Harkin
CHECKED	

NOTE: ENSURE SCORPION SYSTEM IS CLEAR OF MOVING PARTS AND ALL ORIGINAL FUNCTIONS WORK CORRECTLY.

A) Remove original exhaust from bike, taking care to keep all original components in a safe place.

B) Refit Scorpion exhaust as per line diagram above.

C) When fitted take bike for a short ride to ensure all functions are correct.

D) When bike & exhaust are cool enough check all nuts and bolts are still secure.