

BIKE	HONDA MSX 125cc	PART NO.	RHA-170
YEAR	2013- Current	FIT KITS	Z039.10547
NOTES	Use standard fittings where not supplied. USE O.E GASKET	DB-Killer	SCEXDBK26 - (Type X)

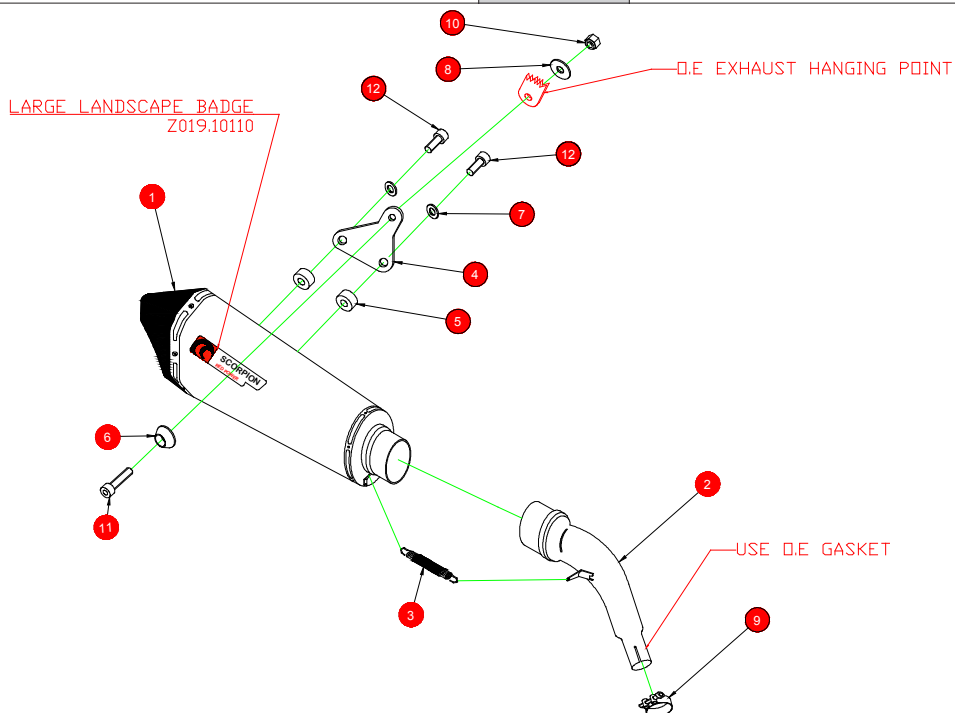

- | | |
|--|---|
| 1 275mm Serket Taper Silencer RSC 336 | 8 M8x25mm Washer (Z017.10825) |
| 2 Connecting Pipe CP857 | 9 31-34mm Clamp (Z016.10059) |
| 3 Rubber Coated Spring (Z028.10030) | 10 M8 Nyloc Nut (Z017.10062) |
| 4 Mounting Bracket (Z015.31256) | 11 M8x20mm Cap Head Bolt (Z017.10072) |
| 5 2 x 5mm Aluminium Spacers (Z026.20049) | 12 2 x M8x16 Cap Head Bolt (Z017.10808) |
| 6 Alloy Bolt Finisher (Z026.20068) | |
| 7 2 x M8x17mm Washer (Z017.10831) | |

E-MARK	RSC336 [E11] 0938
ISSUE NO.	04
DATE	17/10/2018
AUTHORISED	J.Harkin
CHECKED	

NOTE: ENSURE SCORPION SYSTEM IS CLEAR OF MOVING PARTS AND ALL ORIGINAL FUNCTIONS WORK CORRECTLY.



A) Remove original exhaust, taking care not to lose or damage any of the original components.

B) Fit the Scorpion Exhaust as per line diagram above.

C) When fitted, take bike for a short test run, upon return allow bike to cool and check all nuts and bolts are secure.

Box: PLOCK 1

BIKE	HONDA MSX 125cc	PART NO.	RHA-170
YEAR	2013- Current	FIT KITS	Z039.10547
NOTES		FEATURES	

Thank you for purchasing your Scorpion Silencer.

Care of your exhaust: Please refrain from cleaning silencer with heavy solvents or abrasives!

Vielen Dank Fur den kauf eines Scorpion Schalldampfers! Pflegehinweis: Bitte verwenden Sie niemals Scheuermittel oder aggressive Reiniger zur Pflege Ihres Auspuffes!

Merci d'avoir choisi un echappement Scorpion.

Entretien de votre silencieux: Ne pas utiliser de solvants ou de produits abrasifs!

"Muchas gracias por adquirir un Silencioso Scorpion. Le recomendamos no limpiar el silencioso con productos abrasivos o aquellos que contengan disolventes."