

BIKE	KTM 125 Duke / Duke 200	PART NO.	RKT-72
YEAR	2011 - 16 / 2012 - 16	FIT KITS	Z039.20428
NOTES	Remove original bolt behind heel plate then fit item 9	DB-Killer	SCEXDBK23 - (Type V)

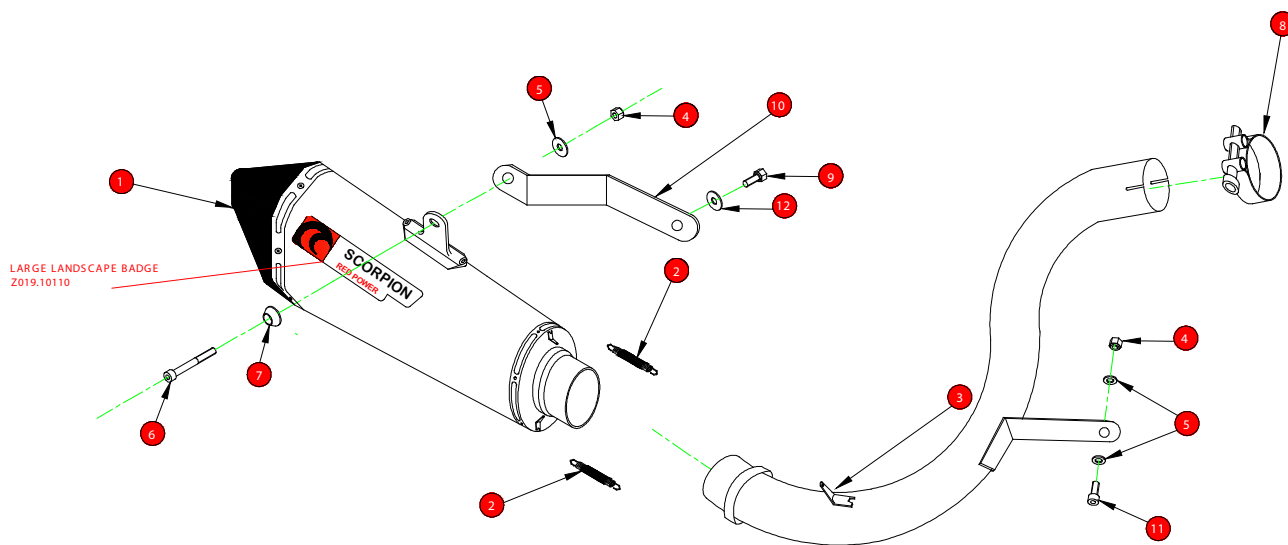

- 1 Serket Conical Silencer RSC 214
- 2 2 x Red Power Springs (Z028.10030)
- 3 Connecting Pipe CP653
- 4 2 x M8 Nyloc Nut (Z017.10062)
- 5 3 x M8 x 17mm Washer (Z017.10831)
- 6 M8 x 25mm Caphead Bolt (Z017.10073)
- 7 Aluminium Bolt Finisher (Z026.20068)

- 8 40-43mm Band Clamp (Z016.10007)
- 9 M6 x 20mm Hex Head Bolt (Z017.10611)
- 10 Silencer Mounting Bracket (Z015.30940)
- 11 M8 x 20mm Caphead Bolt (Z017.10072)
- 12 M6 x 12mm Washer (Z017.10617)

CLASSIFICATION	Closed Circuit Product
HOMOLOGATED	No
ISSUE NO.	06
DATE	14/04/21
AUTHORISED	M.Ydlibi
CHECKED	

NOTE: ENSURE SCORPION SYSTEM IS CLEAR OF MOVING PARTS AND ALL ORIGINAL FUNCTIONS WORK CORRECTLY.



A) Remove original exhaust from bike, taking care to keep all original components in a safe place.

B) Refit Scorpion exhaust as per line diagram above.

C) When fitted take bike for a short ride to ensure all functions are correct.

D) When bike & exhaust are cool enough check all nuts and bolts are still secure.

Cleaning instructions overleaf:

Box: PLOCK 2

BIKE	KTM 125 Duke / Duke 200	PART NO.	RKT-72
YEAR	2011 - ON / 2012 - ON	FIT KITS	Z039.20428
NOTES		FEATURES	

Thank you for purchasing your Scorpion Silencer.

Care of your exhaust: Please refrain from cleaning silencer with heavy solvents or abrasives!

Vielen Dank für den Kauf eines Scorpion Schalldämpfers! Pflegehinweis: Bitte verwenden Sie niemals Scheuermittel oder aggressive Reiniger zur Pflege Ihres Auspuffes!

Merci d'avoir choisi un échappement Scorpion.

Entretien de votre silencieux: Ne pas utiliser de solvants ou de produits abrasifs!

"Muchas gracias por adquirir un Silencioso Scorpion. Le recomendamos no limpiar el silencioso con productos abrasivos o aquellos que contengan disolventes."