

Box: PLOCK 2

BIKE	SUZUKI GSF 600 BANDIT	PART NO.	ESI - 54
YEAR	1995 - 2000	FIT KITS	OVAL Z039.11080 // ROUND Z039.10080
NOTES	Use standard fittings where not supplied Remove standard gasket if fitted.	DB-Killer	SCEXDBK12 - (Type B)

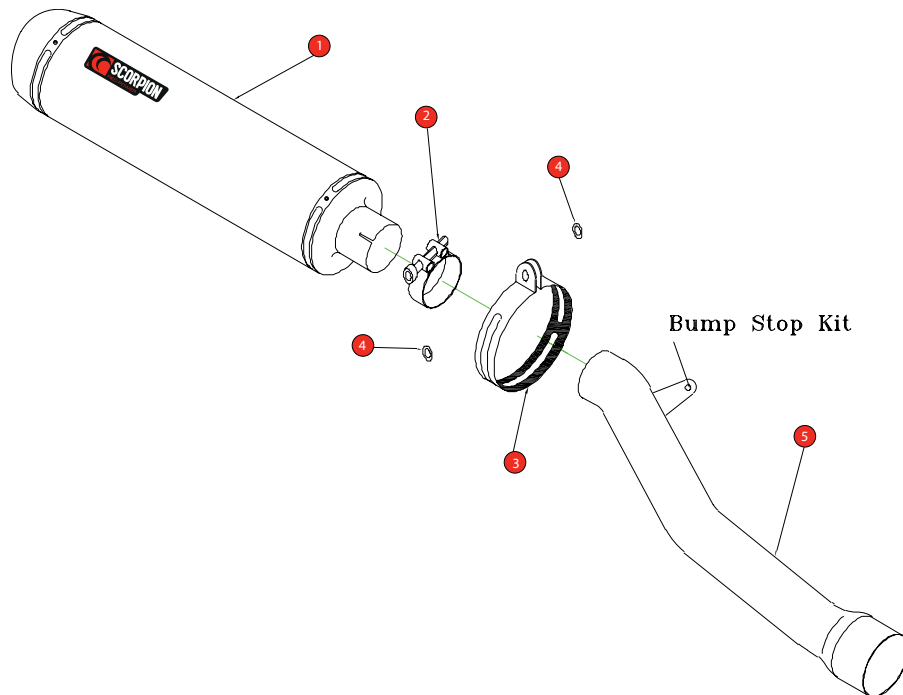

- | | |
|---|--|
| 1 | 450mm Silencer ESC 50 |
| 2 | 51-55mm Band Clamp (Z016.10002) |
| 3 | Composite Silencer Strap(R-Z038.10089)(O-Z038.10087) |
| 4 | 2 x M8 x 25mm Washers (Z017.10825) |
| 5 | Connecting Pipe CP 33 |
| 6 | Bump Stop Kit (Z017.10010) |

E-MARK ROUND	SCDB-RS e4 2035
E-MARK OVAL	SCDB-OS e4 2072
ISSUE NO.	10
DATE	19/10/2018
AUTHORISED	J.Harkin
CHECKED	

NOTE: ENSURE SCORPION SYSTEM IS CLEAR OF MOVING PARTS AND ALL ORIGINAL FUNCTIONS WORK CORRECTLY.

A) Remove original exhaust from bike, taking care to keep all original components in a safe place.

B) Refit Scorpion exhaust as per line diagram above.

C) When fitted take bike for a short ride to ensure all functions are correct.

D) When bike & exhaust are cool enough check all nuts and bolts are still secure.