

Box: PLOCK 2

BIKE	SUZUKI GSF 600 / 650 BANDIT	PART NO.	ESI - 67
YEAR	2000 - 2006	FIT KITS	OVAL Z039.11081 // ROUND Z039.10081
NOTES	Use standard fittings where not supplied Remove standard gasket if fitted.	DB-Killer	SCEXDBK12 - (Type B)

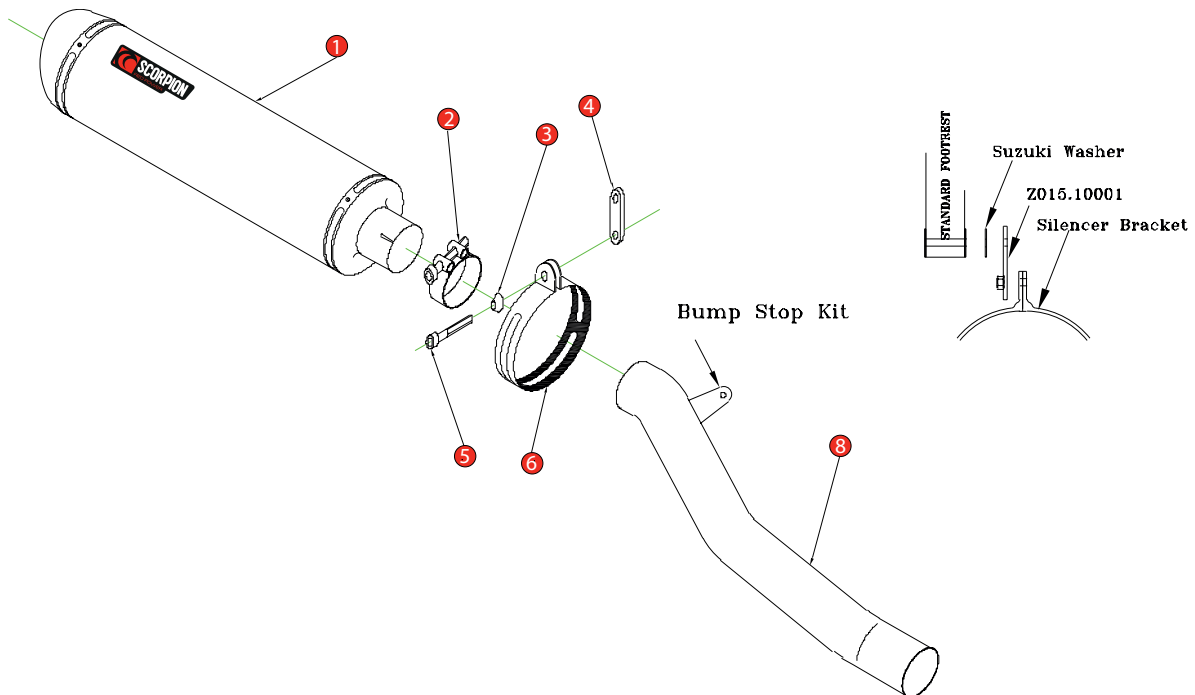

1	450mm Silencer ESC 50	8	Bump Stop Kit
2	51-55mm Band Clamp (Z016.10002)		
3	Alloy Bolt Finisher (Z026.20068)		
4	Mounting Bracket (Z015.10001)		
5	M8 x 16mm Cap Head Bolt (Z017.10808)		
6	Composite Silencer Strap (R-Z038.10090)(O-Z030.10088)		
7	Connecting Pipe CP 33		

E-MARK ROUND	SCDB-RS [e4] 2035
E-MARK OVAL	SCDB-OS [e4] 2072
ISSUE NO.	08
DATE	19/10/2018
AUTHORISED	J.Harkin
CHECKED	

NOTE: ENSURE SCORPION SYSTEM IS CLEAR OF MOVING PARTS AND ALL ORIGINAL FUNCTIONS WORK CORRECTLY.



A) Remove original exhaust from bike, taking care to keep all original components in a safe place.

B) Refit Scorpion exhaust as per line diagram above.

C) When fitted take bike for a short ride to ensure all functions are correct.

D) When bike & exhaust are cool enough check all nuts and bolts are still secure.