

Box: PLOCK 2x2

BIKE	Yamaha TDM-900	PART NO.	EYA-67
YEAR	2002-13	FIT KITS	OVAL Z039.11125 / ROUND Z039.10125
NOTES	Use standard fittings where not supplied <b>Remove standard gasket if fitted.</b>	DB-Killer	2 x SCEXDBK12 - (Type B)

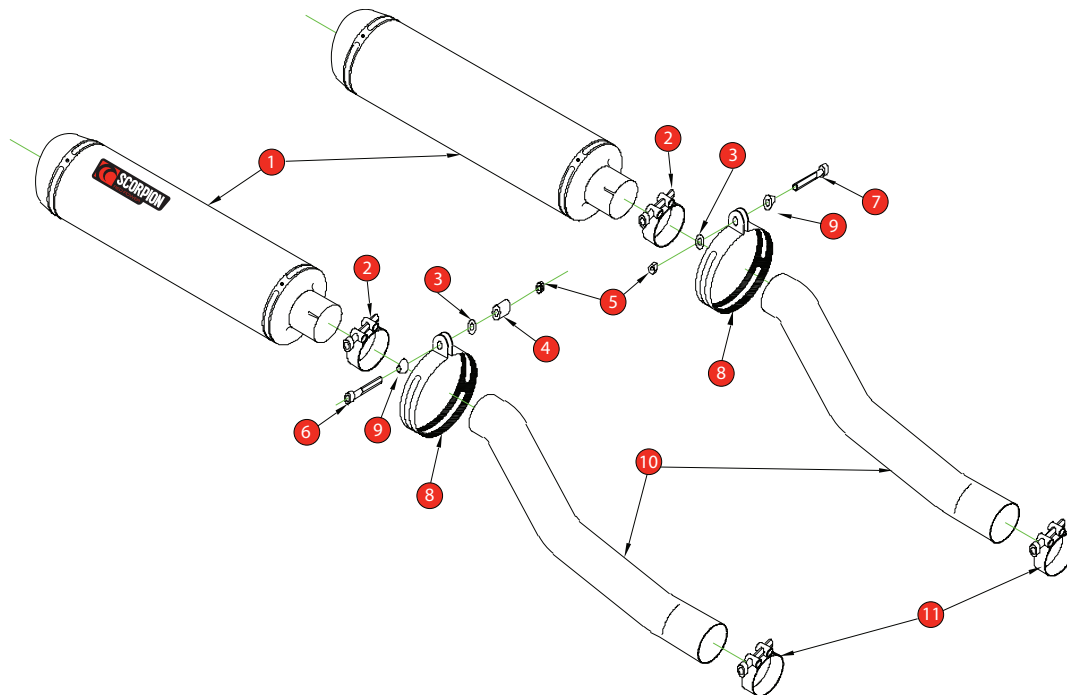

- |  |  |
|--|--|
| 1 2 x 400mm Silencers ESC 95           | 8 2 x Comp Silencer Straps(R-Z038.10090)(O-Z038.10088) |
| 2 2 x 51-55mm Band Clamps (Z016.10002) | 9 2 x Alloy Bolt Finishers (Z026.20068)                |
| 3 2 x M8 x 25mm Washers (Z017.10825)   | 10 2 x Connecting Pipes CP 232                         |
| 4 15mm Aluminium Spacer (Z026.10005)   | 11 2 x 40-43mm Band Clamps (Z016.10007)                |
| 5 2 x M8 Nyloc Nuts (Z017.10062)       |  |
| 6 M8 x 45mm Cap Head Bolt (Z017.10077) |  |
| 7 M8 x 30mm Cap Head Bolt (Z017.10074) |  |

E-MARK ROUND	<a href="#">SCBM-R E4 2134</a>
E-MARK OVAL	<a href="#">SCBM-O E4 2135</a>
ISSUE NO.	07
DATE	22/10/2018
AUTHORISED	J,Harkin
CHECKED	

**NOTE:** ENSURE SCORPION SYSTEM IS CLEAR OF MOVING PARTS AND ALL ORIGINAL FUNCTIONS WORK CORRECTLY.

A) Remove original exhaust from bike, taking care to keep all original components in a safe place.

B) Refit Scorpion exhaust as per line diagram above.

C) When fitted take bike for a short ride to ensure all functions are correct.

D) When bike & exhaust are cool enough check all nuts and bolts are still secure.