

Box: PLOCK 1

BIKE	HONDA CB 1000 R	PART NO.	EHA - 101
YEAR	2008-2017	FIT KITS	OVAL Z039.11307
NOTES	Use standard fittings where not supplied Remove standard gasket if fitted.	DB-Killer	SCEXDBK12 - (Type B)

Cat Replacement Pipe (EHA-101-CR) & Carbon Fibre Panel (EHA-101-CFP) Also Available

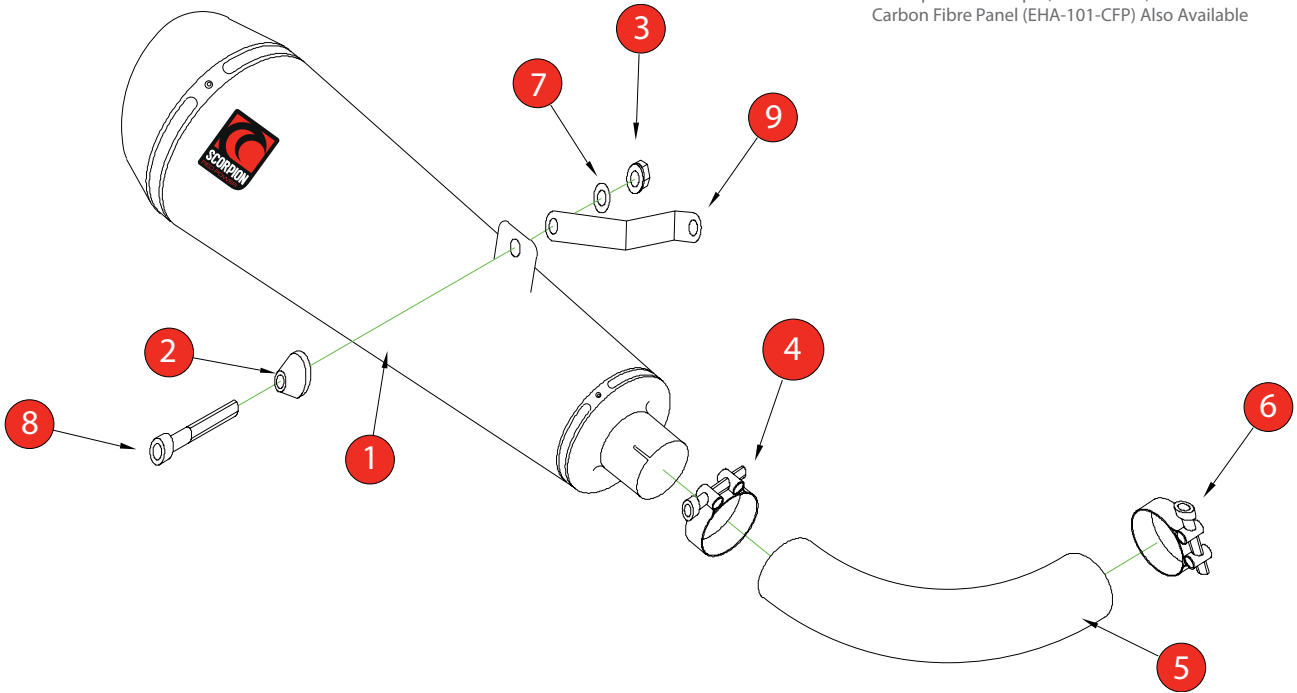

- | | |
|--|--|
| 1 275mm Coned Slip On Silencer ESC 138 | 8 M8 x 16mm Cap Head Bolt (Z017.10808) |
| 2 Aluminium Bolt Finisher (Z026.20068) | 9 Silencer Mounting Bracket (Z015.10890) |
| 3 M8 Nyloc Nut (Z017.10062) | 10 47-51mm Band Clamp (Z016.10003) |
| 4 51-55mm Band Clamp (Z016.10002) | 11 2 x M8 Nyloc nuts (Z017.10062) |
| 5 Connecting Pipe CP 485 | 12 Photo fitting instructions |
| 6 47-51mm Band Clamp (Z016.10003) | |
| 7 M8 x 17mm Washer (Z017.10831) | |

E-MARK ROUND	N/A
E-MARK OVAL	HA-101 E4 2338 ©
ISSUE NO.	6
DATE	09/10/2018
AUTHORISED	J.Harkin
CHECKED	

NOTE: ENSURE SCORPION SYSTEM IS CLEAR OF MOVING PARTS AND ALL ORIGINAL FUNCTIONS WORK CORRECTLY.



A) Remove original exhaust from bike, taking care to keep all original components in a safe place.

B) Refit Scorpion exhaust as per line diagram above.

C) When fitted take bike for a short ride to ensure all functions are correct.

D) When bike & exhaust are cool enough check all nuts and bolts are still secure.