

<b>Bike</b>	Kawasaki Z900 RS / RS Cafe	<b>Part No.</b>	PKA-123
<b>Year</b>	2018-Current	<b>Fit Kit</b>	Z039.10639
<b>Notes</b>	Where not supplied use original fittings	<b>dB Killer</b>	SCEXDBK46 - (TYPE PA)

Estimated Fitting Time: 60 Minutes

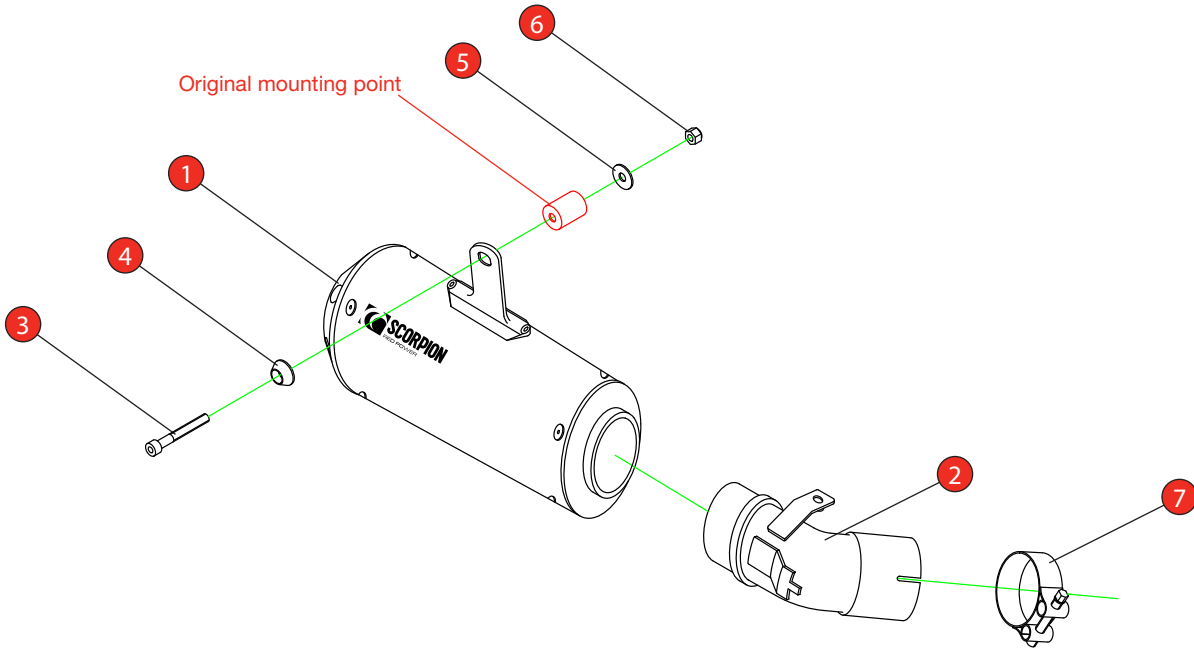

NO.	PART NO.	DESCRIPTION	QTY
1	PSC440	Red Power Silencer	1
2	CP991	Connecting Pipe	1
<b>Fit Kit - Z039.10639</b>			
3	Z017.10076	M8 x 40mm Cap Head Bolt	1
4	Z026.20068	Alloy Bolt Finisher	1
5	Z017.10825	M8 x 25mm Washer	1
6	Z017.10062	M8 Nyloc Nut	1
7	Z016.10002	51-55mm Clamp	1

CLASSIFICATION	Closed Circuit Product
HOMOLOGATED	No
DATE	03/08/21
ISSUE	03
AUTHORISED	M.Ydilibi

**NOTE:** ENSURE SCORPION SYSTEM IS CLEAR OF MOVING PARTS AND ALL ORIGINAL FUNCTIONS WORK CORRECTLY.

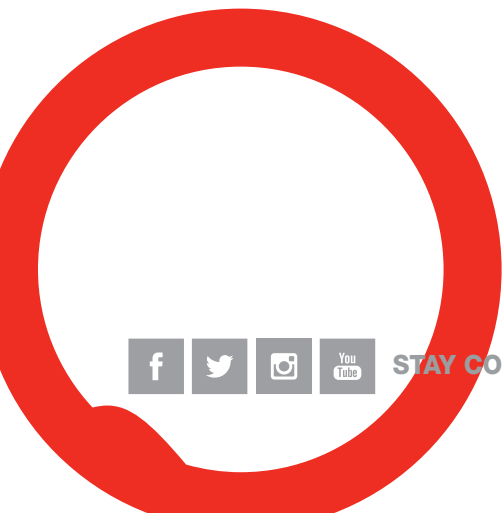

STAY CONNECTED TO RED POWER.

<b>Bike</b>	Kawasaki Z900 RS / RS Cafe	<b>Part No.</b>	PKA-123
<b>Year</b>	2018-Current	<b>Fit Kit</b>	Z039.10639
<b>Notes</b>	Where not supplied use original fittings	<b>dB Killer</b>	SCEXDBK46 - (TYPE PA)



A) Remove the original exhaust in one piece and retain all fittings.

B) Unbolt the original heat shield and remove it from the original exhaust.

C) Carefully remove the rubber from the original exhaust.

D) Fit the rubber on to the Scorpion connecting pipe.

E) Slide the heat shield onto the Scorpion connecting pipe, use the original bolt to secure it in place.

F) Fit the Scorpion connecting pipe using the clamp provided in the fit kit.

G) Fit the silencer to the connecting pipe using the fittings provided. When fitted take bike for a short ride upon return allow the bike to cool and check all fittings are still secure.



<b>Bike</b>	Kawasaki Z900 RS / RS Cafe	<b>Part No.</b>	PKA-123
<b>Year</b>	2018-Current	<b>Fit Kit</b>	Z039.10639
<b>Notes</b>	Where not supplied use original fittings	<b>dB Killer</b>	SCEXDBK46 - (TYPE PA)

Estimated Fitting Time: 60 Minutes



A) Remove original exhaust from bike, taking care to keep all original components in a safe place.

B) Refit Scorpion exhaust as per line diagram above.

C) When fitted take bike for a short ride to ensure all functions are correct.

D) When bike & exhaust are cool enough check all nuts and bolts are still secure.

Thank you for purchasing your Scorpion Silencer.

Care of your exhaust: Please refrain from cleaning silencer with heavy solvents or abrasives!

Vielen Dank Für den kauf eines Scorpion Schalldampfers! Pflegehinweis: Bitte verwenden Sie niemals Scheuermittel oder aggressive Reiniger zur Pflege Ihres Auspuffes!

Merci d'avoir choisi un echappement Scorpion.

Entretien de votre silencieux: Ne pas utiliser de solvants ou de produits abrasifs!

Muchas gracias por adquirir un Silencioso Scorpion. Le recomendamos no limpiar el silencioso con productos abrasivos o aquellos que contengan disolventes.



STAY CONNECTED TO RED POWER.