

<b>Bike</b>	Kawasaki Z125	<b>Part No.</b>	PKA-126
<b>Year</b>	2018-Current	<b>Fit Kit</b>	Z039.10648
<b>Notes</b>	Where not supplied use original fittings. Remove OE Silencer Gasket if fitted.	<b>dB Killer</b>	SCEXDBK50 - (TYPE PD)

Estimated Fitting Time: 45 Minutes

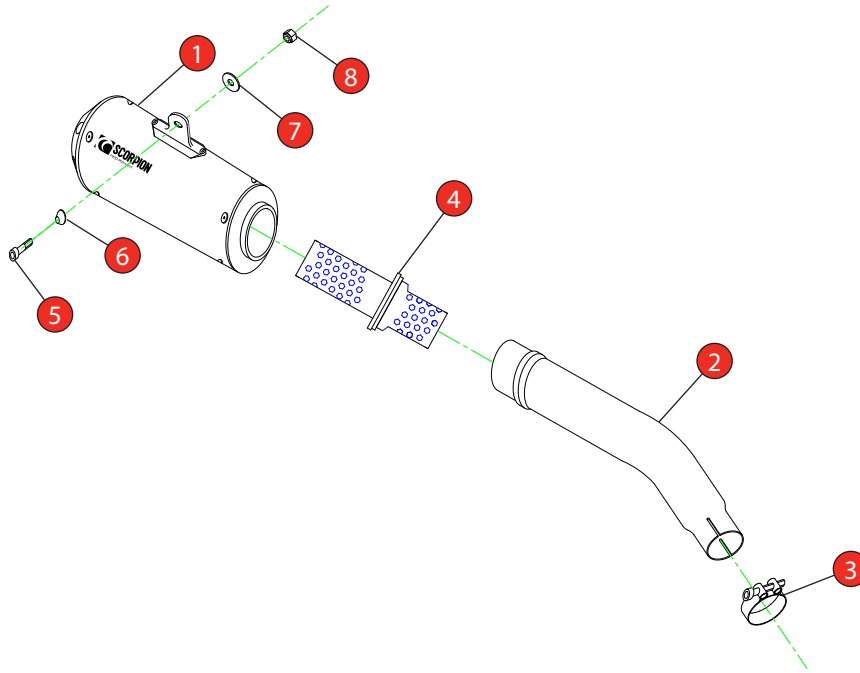

NO.	PART NO.	DESCRIPTION	QTY
1	PSC449	300mm Serket Parallel Silencer	1
2	CP1018	Connecting Pipe	1
<b>Fit Kit - Z039.10647</b>			
3	Z016.10006	37-40mm Band Clamp	1
4	Z028.20385	Short Double Ended Flute (Closed)	1
5	Z017.10080	M8x60mm Caphead Bolt	1
6	Z026.20068	Alloy Bolt Finisher	1
7	Z017.10825	M8x25mm Washer	1
8	Z017.10062	M8 Nyloc Nut	1

E-MARK	BSAU 193a 1993t3
DATE	13/03/2019
ISSUE	00
AUTHORISED	J.Harkin

**NOTE:** ENSURE SCORPION SYSTEM IS CLEAR OF MOVING PARTS AND ALL ORIGINAL FUNCTIONS WORK CORRECTLY.

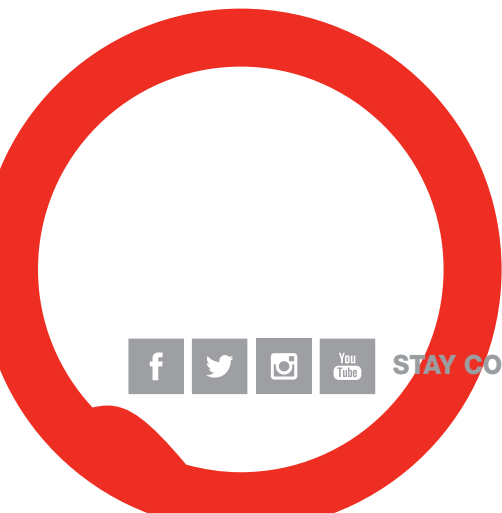

STAY CONNECTED TO RED POWER.

<b>Bike</b>	Kawasaki Z125	<b>Part No.</b>	PKA-126
<b>Year</b>	2018-Current	<b>Fit Kit</b>	Z039.10648
<b>Notes</b>	Where not supplied use original fittings. Remove OE Silencer Gasket if fitted.	<b>dB Killer</b>	SCEXDBK50 - (TYPE PD)

Estimated Fitting Time: 45 Minutes



A) Remove original exhaust from bike, taking care to keep all original components in a safe place.

B) Refit Scorpion exhaust as per line diagram above.

C) When fitted take bike for a short ride to ensure all functions are correct.

D) When bike & exhaust are cool enough check all nuts and bolts are still secure.

Thank you for purchasing your Scorpion Silencer.

Care of your exhaust: Please refrain from cleaning silencer with heavy solvents or abrasives!

Vielen Dank Für den kauf eines Scorpion Schalldampfers! Pflegehinweis: Bitte verwenden Sie niemals Scheuermittel oder aggressive Reiniger zur Pflege Ihres Auspuffes!

Merci d'avoir choisi un echappement Scorpion.

Entretien de votre silencieux: Ne pas utiliser de solvants ou de produits abrasifs!

Muchas gracias por adquirir un Silencioso Scorpion. Le recomendamos no limpiar el silencioso con productos abrasivos o aquellos que contengan disolventes.



STAY CONNECTED TO RED POWER.