

Bike	Honda CBR 650 R	Part No.	RHA190
Year	2019- on	Fit Kit	Z039.10661
Notes	Where not supplied use original fittings	dB Killer	SCEXDBK24 - (Type W)

Estimated Fitting Time: 60 Minutes

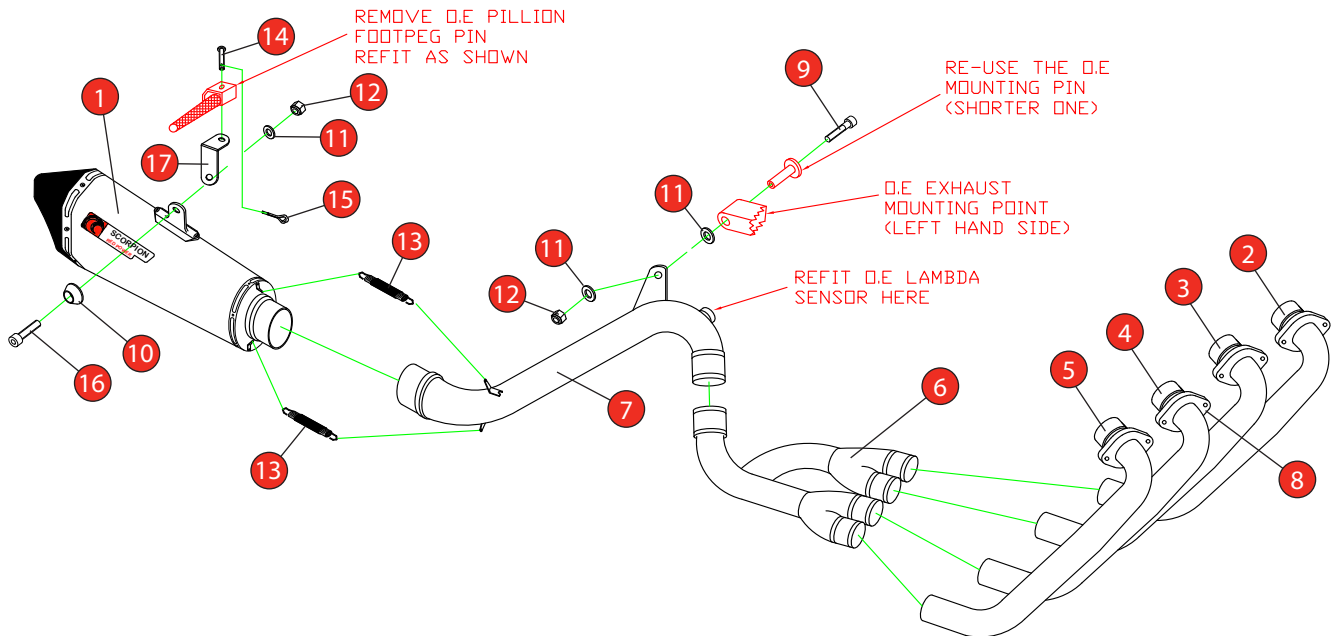

NO.	PART NO.	DESCRIPTION	QTY
1	RSC252	Serket Taper Silencer	1
2	CP824	Connecting Pipe	1
3	CP825	Connecting Pipe	1
4	CP826	Connecting Pipe	1
5	CP827	Connecting Pipe	1
6	CP828	Connecting Pipe	1
7	CP1054	Connecting Pipe	1
Fit Kit - Z039.10661			
8	Z007.30981	Flange	4
9	Z017.10079	M8 x 55mm Cap Head Bolt	1
10	Z026.20068	Alloy Bolt Finisher	1
11	Z017.10825	M8 x 25mm Washer	3
12	Z017.10062	M8 Nyloc Nut	2
13	Z028.10030	Rubber Coated Spring	2
14	Z017.10006	M8 x 50 Button Head Bolt With Split Pin Hole	1
15	Z017.10008	Ø3 x 20mm Split Pin	1
16	Z017.10073	M8 x 25mm Cap Head Bolt	1
17	Z015.31249	Mounting Bracket	1

E-MARK	BSAU 193a 1990/t3
DATE	24/09/2019
ISSUE	00
AUTHORISED	D.Marshall



STAY CONNECTED TO RED POWER.

Bike	Honda CBR 650 R	Part No.	RHA190
Year	2019- on	Fit Kit	Z039.10661
Notes	Where not supplied use original fittings	dB Killer	SCEXDBK24 (Type W)

Estimated Fitting Time: 60 Minutes



A) Remove original exhaust from bike, taking care to keep all original components in a safe place.

B) Refit Scorpion exhaust as per line diagram above.

C) When fitted take bike for a short ride to ensure all functions are correct.

D) When bike & exhaust are cool enough check all nuts and bolts are still secure.

Thank you for purchasing your Scorpion Silencer.

Care of your exhaust: Please refrain from cleaning silencer with heavy solvents or abrasives!

Vielen Dank Fur den kauf eines Scorpion Schalldampfers! Pflegehinweis: Bitte verwenden Sie niemals Scheuermittel oder aggressive Reiniger zur Pflege Ihres Auspuffes!

Merci d'avoir choisi un echappement Scorpion.

Entretien de votre silencieux: Ne pas utiliser de solvants ou de produits abrasifs!

Muchas gracias por adquirir un Silencioso Scorpion. Le recomendamos no limpiar el silencioso con productos abrasivos o aquellos que contengan disolventes.



STAY CONNECTED TO RED POWER.